

Digital Label Cutter

Auto Sheet Feed



Use Manual

Read Manual carefully before using

I. Installation

1.1 Take out A-StarCut and parts in package. And tools in A-StarCut front panel.

Tools: Hexagon spanner, Cross screw driver, USB disk (Manual, Software)

1.2 Feeder installation: Hook feeder at back side and fix by two screws on cutter



1.3 Put take up in front of cutter, the magnet will make it fix on cutter

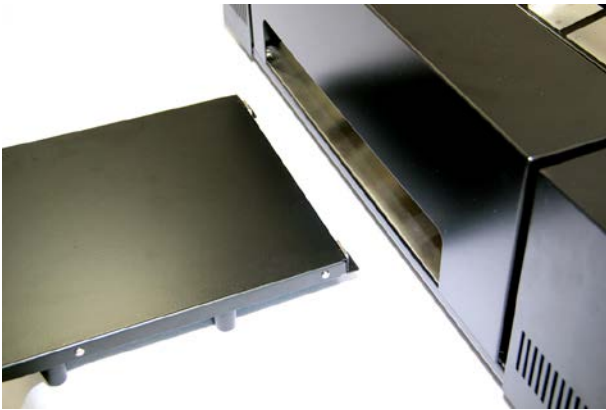

Take up with Magnet

II. Power on

2.1 Connect power cable (the power source must be grounded). Switch on.

LCD will light and try direction button on control panel. Check carriage/cutter works or not

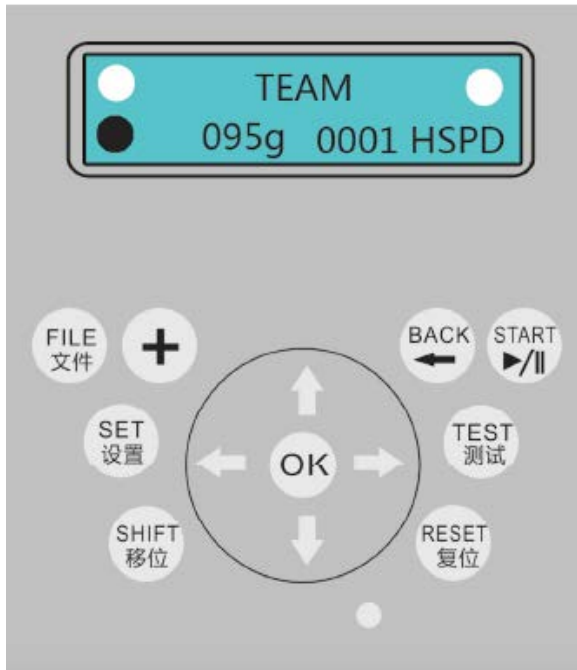

Team: File Name

095g: Cut Force

0001: Copies

HSPD: Carriage Speed (when move by direction button)

2.2 Force

Cut force is tested based on media in factory. Before client use his/her own media. Force test need be done.



Load media, adjust feeder's width



Press down when load media, make sure media touches feeding roll

2.3 Press “Test”, LCD will show as below.

Use Left/Right button moves carriage onto media.

Press “FILE”, media will be load and the stop.Press “TEST” into test menu and choose “Force”

Press “OK” it will cut media.

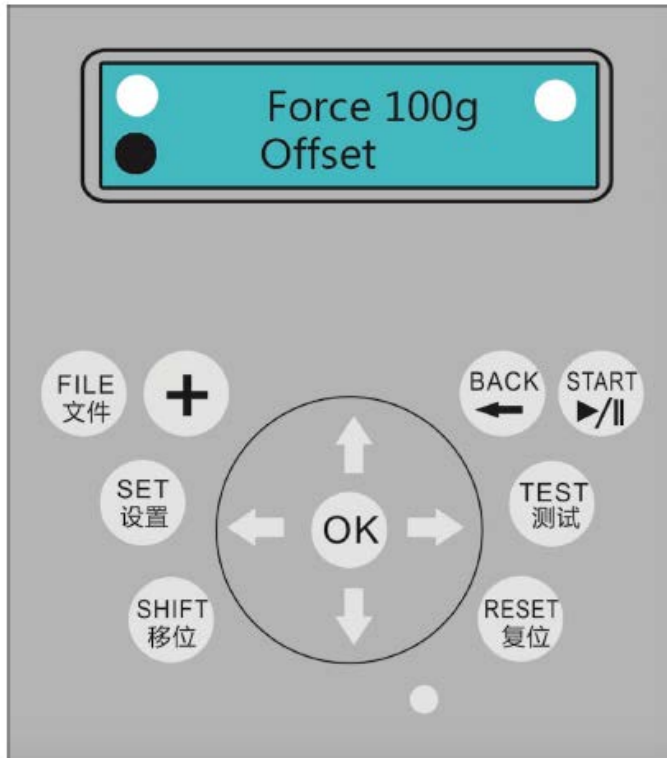

Force not enough



Force too large



Force is OK

If the force is not enough,press“+” to increase force.

If the forece is too large,press “SHIFT” to decrease force.(5g-10g per time is more suitable)

Press “OK” to test again until the result is good.

Press “BACK” to save and exit

III. Make file to print

If A4. Set Page Size to 200mm*287mm

If A3. Set Page Size to 287mm*410mm

Leave 10mm for margin will be ok

Here we use A3 as example

3.1 Use CorelDraw X4 or higher, image and I-mark need be put inside of page

Take A3 as example: Make Page Size to 287*410mm. Load image and typeset. Add frame line to the whole page. Then add 5mm square I-Mark at Top Left, the position must be accurate, move 282mm (287mm-5mm=282mm) to the right side, then add another one at top right.

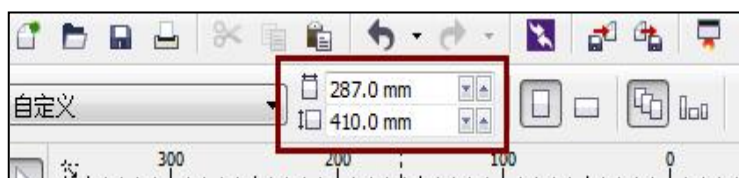

Add 2nd /3rd/4th marks , the distance between 1st and 2nd marks is 30mm.
Distance between 2nd and 3rd marks is 100mm

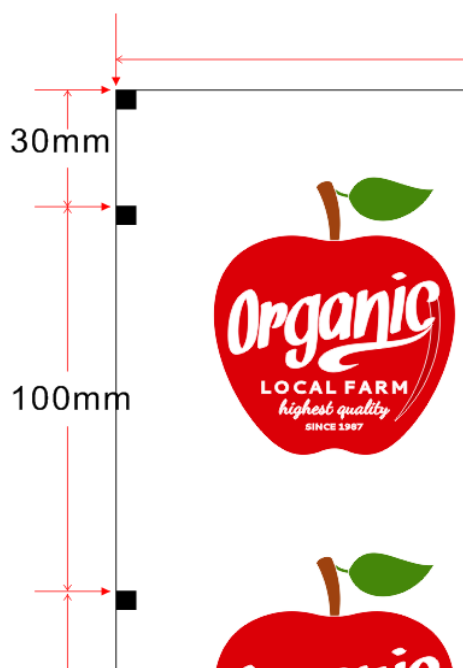

Delete 1st line's Two Marks

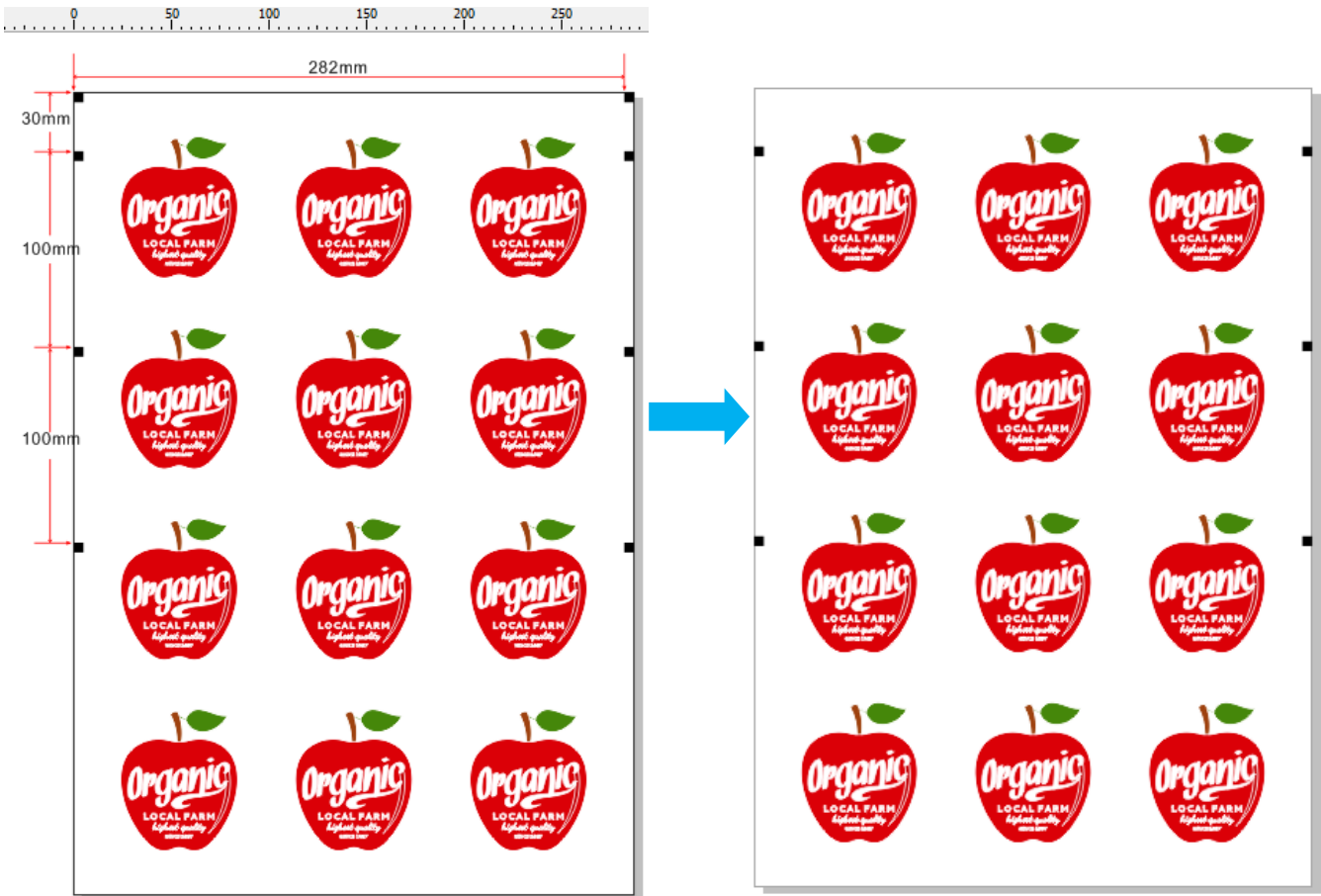

IV. Save PLT

Make all graphics path at the same page, don't move the graphics position during it

After made path, delete all files (marks, image etc) except path. Save and Export to “*.PLT”

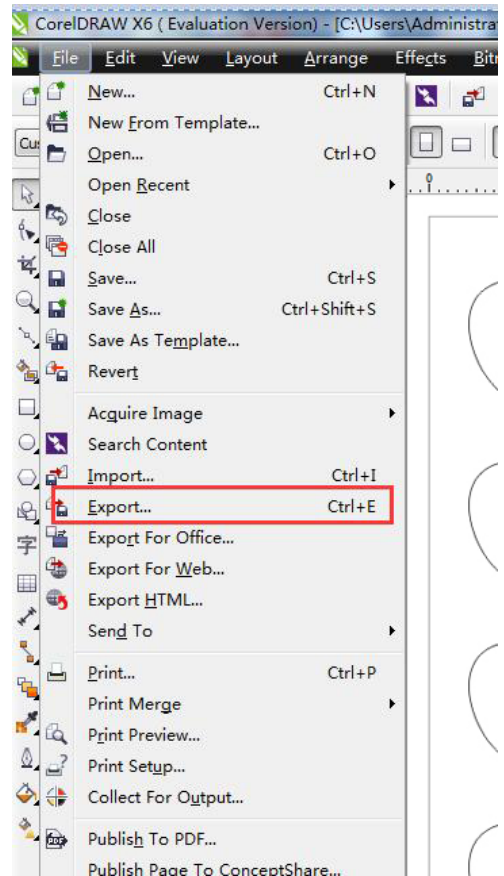
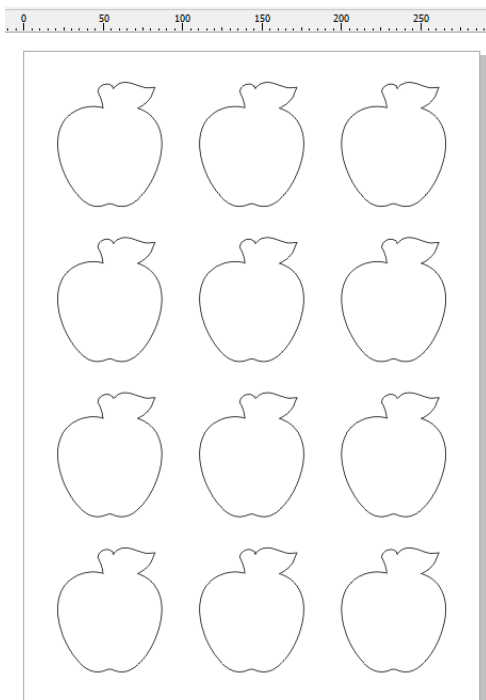

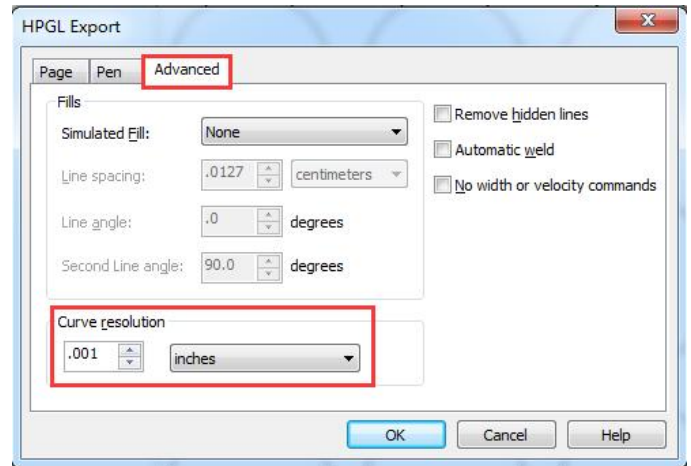
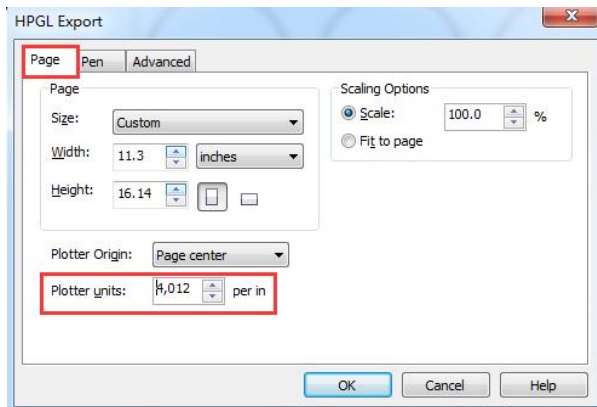
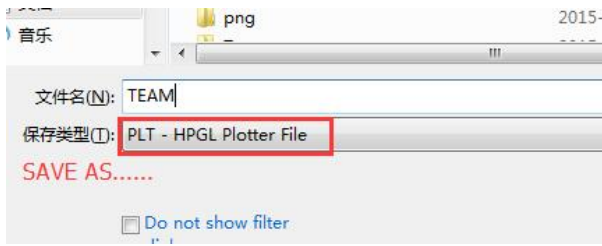

DEFAULT

Plotter Units: 4.012

Curve resolution .0001 inches (When label contains circle)

0.01cm(When label is line/square)

Press "OK" to export the file

V. Install A-StarCut Station. Open it and set relevant value

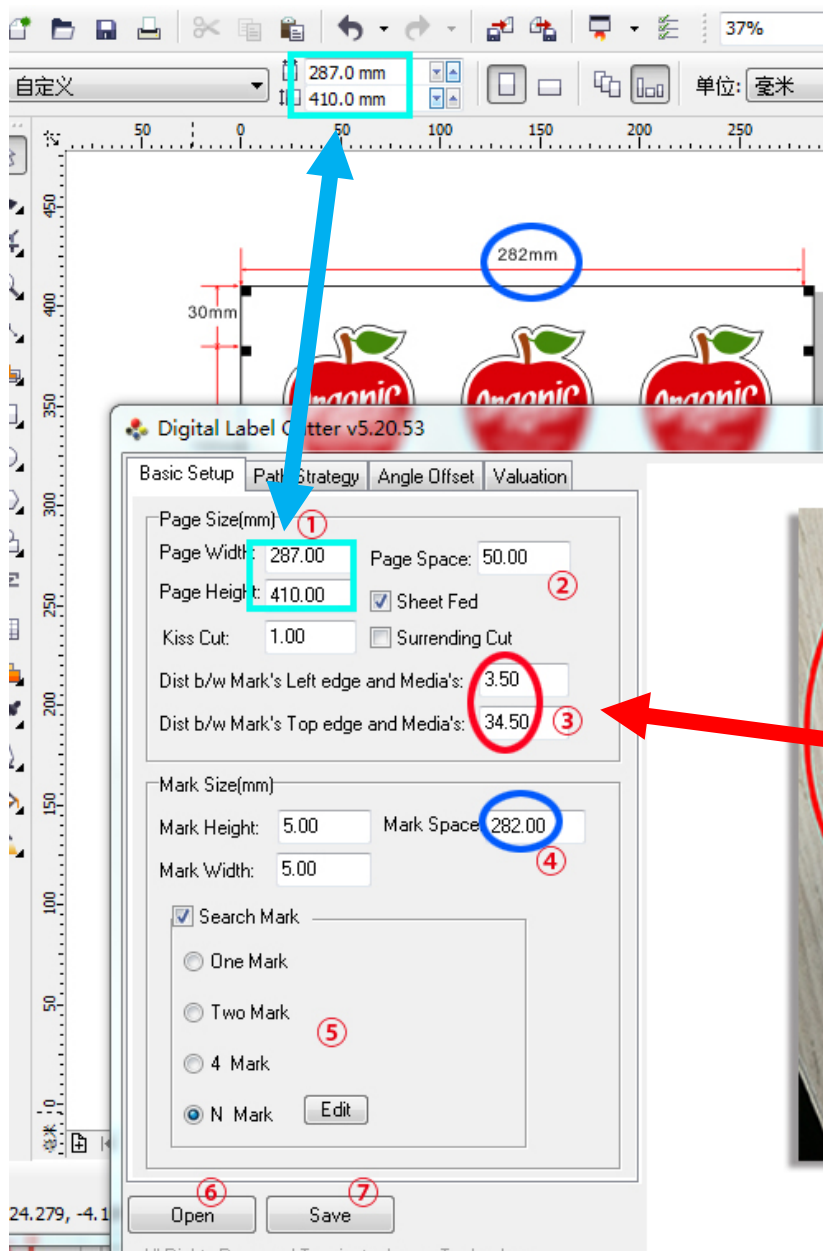

- ① Page Size (In CorelDraw)
- ② Default Value
Select "Sheet Fed"
- ③ Distance from I-mark's margin to Media's margin
Top: 34.50 mm
Left: 3.50 mm



MEASURE BY RULER WHEN PRINT OUT

- ④ Info for Mark
Mark's Len/Wid is 5mm
Distance between two
Marks' center: 282mm

- ⑤ Search Mark
- ⑥ Open "*.plt"
- ⑦ Save to ".plt"

Search Mark

1. Set distance, in this sample it is 100mm.
2. "Add" based on design in CorelDraw
3. Save to go back to main menu

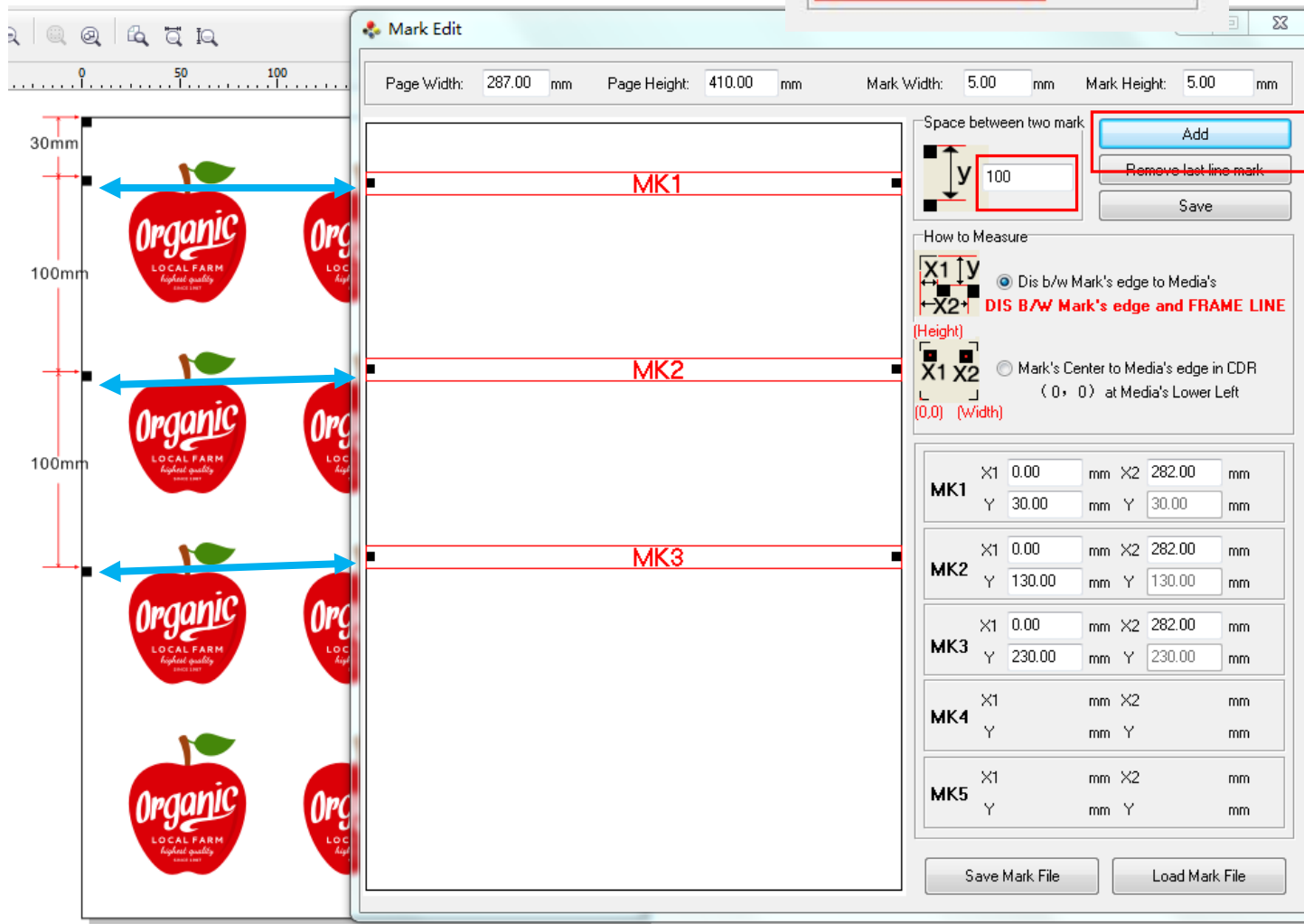
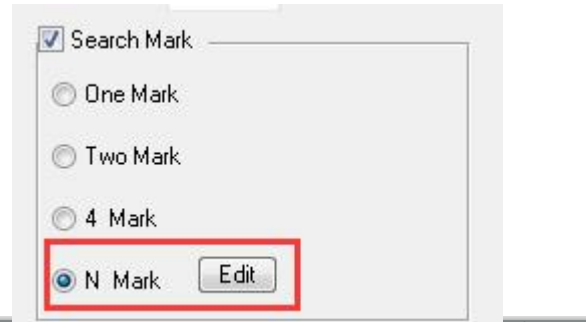

6.1 Export *.apl to USB flash disk. Connect USB on A-StarCut, press "FILE" and Press "+" or "SHIFT" find the file, Press "START" to cut.

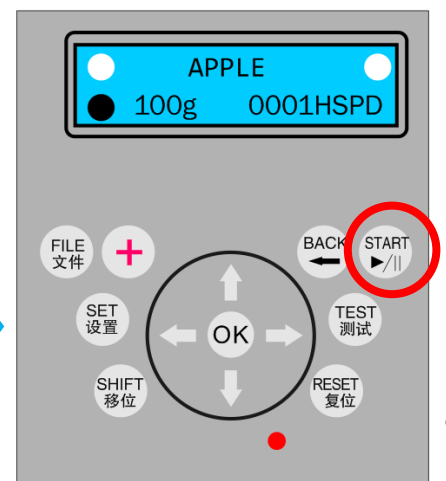
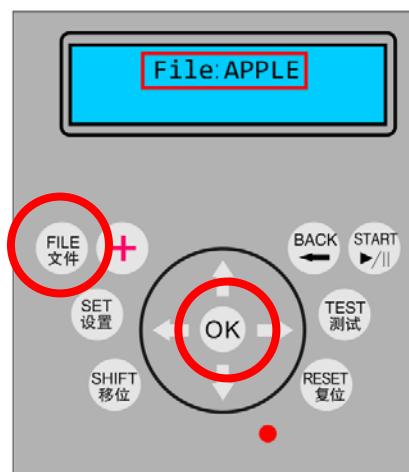

CHAPTER VI is for REFERENCE ONLY

All calibration has been done in factory. If need calibrate, better contact
A-StarCut factory

VI Calibration

The Calibration has already done before leaving factory. The following info is for

A. Reference Only

B. Fine-tune to compensate print device.

- Press “Set” to enter. Press “Down”
find “Offset X” and “Offset Y”

Offset-X:
+21.00mm

Add Value if Cut Path need go Right
If necessary, use Rule to measure and
then adjust.

Offset-Y:
+00.00mm

Add Offset Y's value to make Cut Path
go Down.

Remark:

Left/Right to select value

“+” to add, “Shift” to minus

For Offset-Y, when select “+”, press “Shift” it will
change to “-“.

Eg. When Offset-Y is “+00.00mm”, you want minus
1mm, we will change it to “-01.00mm”

- Press Down to find Ratio X and Ratio Y

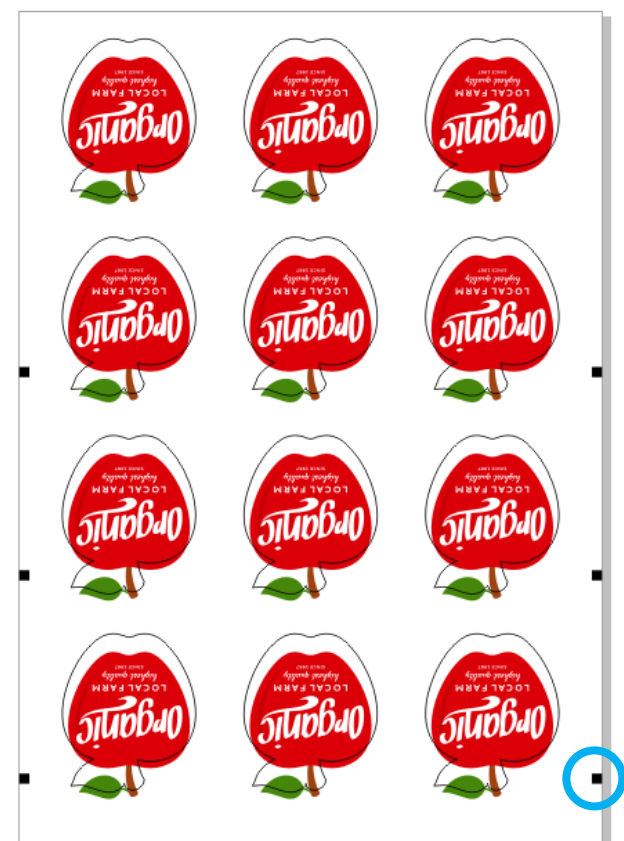
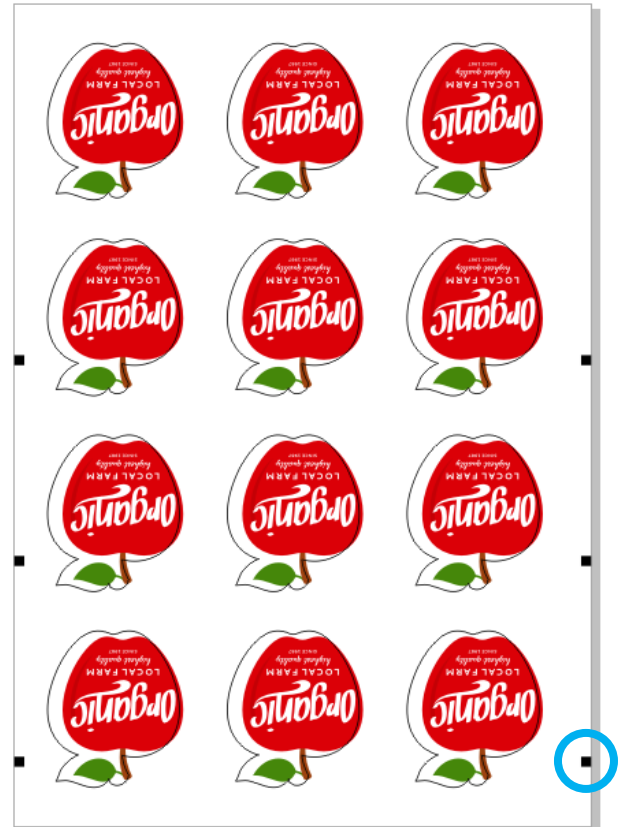

Ratio-X:
1.0000

Minus Value if Cut Path need go left
Normally adjust 4th/5th value

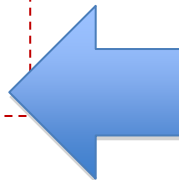

Ratio X

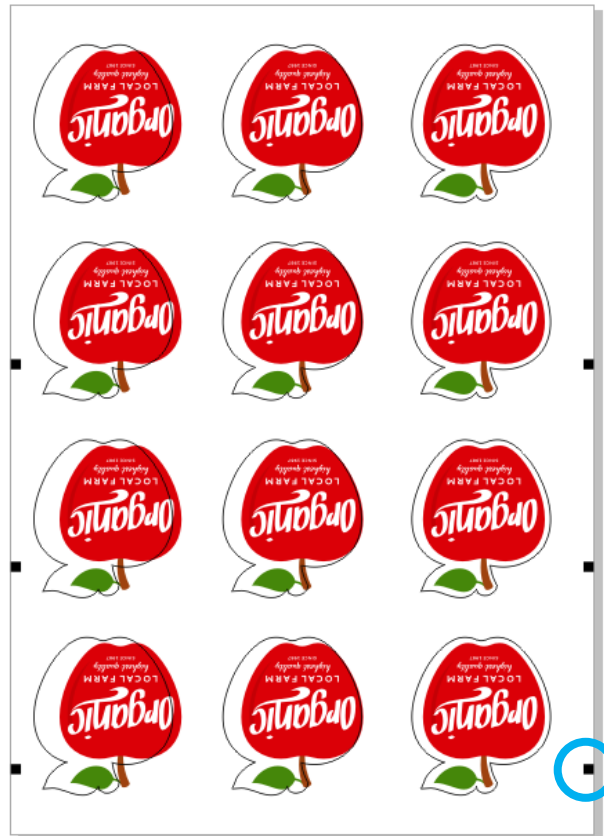

Ratio-Y:
1.0000

Minus Value if Cut Path need go left
Normally adjust 4th/5th value

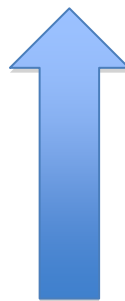

Ratio Y

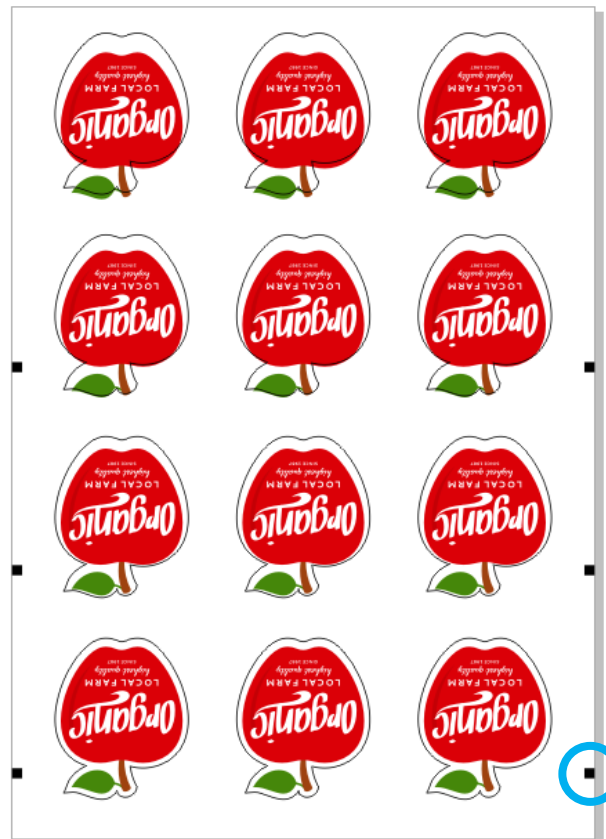

Remark:

Ratio means Zoom in/out based on Original Point's Center

Way to calculate is use Rule measure **Cut Length (from Original Point's Center Point)**, and then divided by **Design Length**(Path make in CorelDraw)

Ratio X= Cut Length(X Direction) / Designed Length(X Direction)

Ratio Y= Cut Length(Y Direction) / Designed Length(Y Direction)

Press Down find “Rotate” on LCD

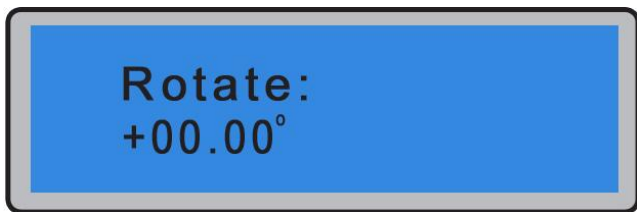

If Cut Path need rotate to LEFE,
(anticlockwise)
Press ‘Shift’ first, then adjust the 3rd/4th
value

Remark:

Left/Right to select value

“+” to add, “Shift” to minus

When select “+”, press “Shift” it will change to “-“.

“+” to rotate clockwise, “Shift” to rotate anticlockwise



Remark: DEFAULT SET

Name	Value	Name	Value
Speed	30cm/s	Offset X	21.00mm
Offset Y	0.00mm	Ratio X	1.000
Ratio Y	1.000	Rotate	0.00
Start	0—10cm		